

# MO-RANCH

**At Mabee Building**  
 Guest Services  
 Meeting Services  
 Sales Office  
 Bookstore  
 Dishman Auditorium  
 Trull Classrooms  
 Library  
 Restrooms

	Main Road		Administration
	Other Road		Lodging
	Elevated Walkway		Meeting & Other
	Walkway		Bird Watching
	Trail		
	Parking		
	Restroom		
	Defibrillator		
	Meditation		

**Contact Information**  
 2229 FM 1340  
 Hunt, Texas 78024-3037  
 (800) 460-4401 Main  
 www.moranch.org

**ANDREW EDINGTON CAMPGROUND**

- Campsite
- Dirt Road
- Cabin
- Trail

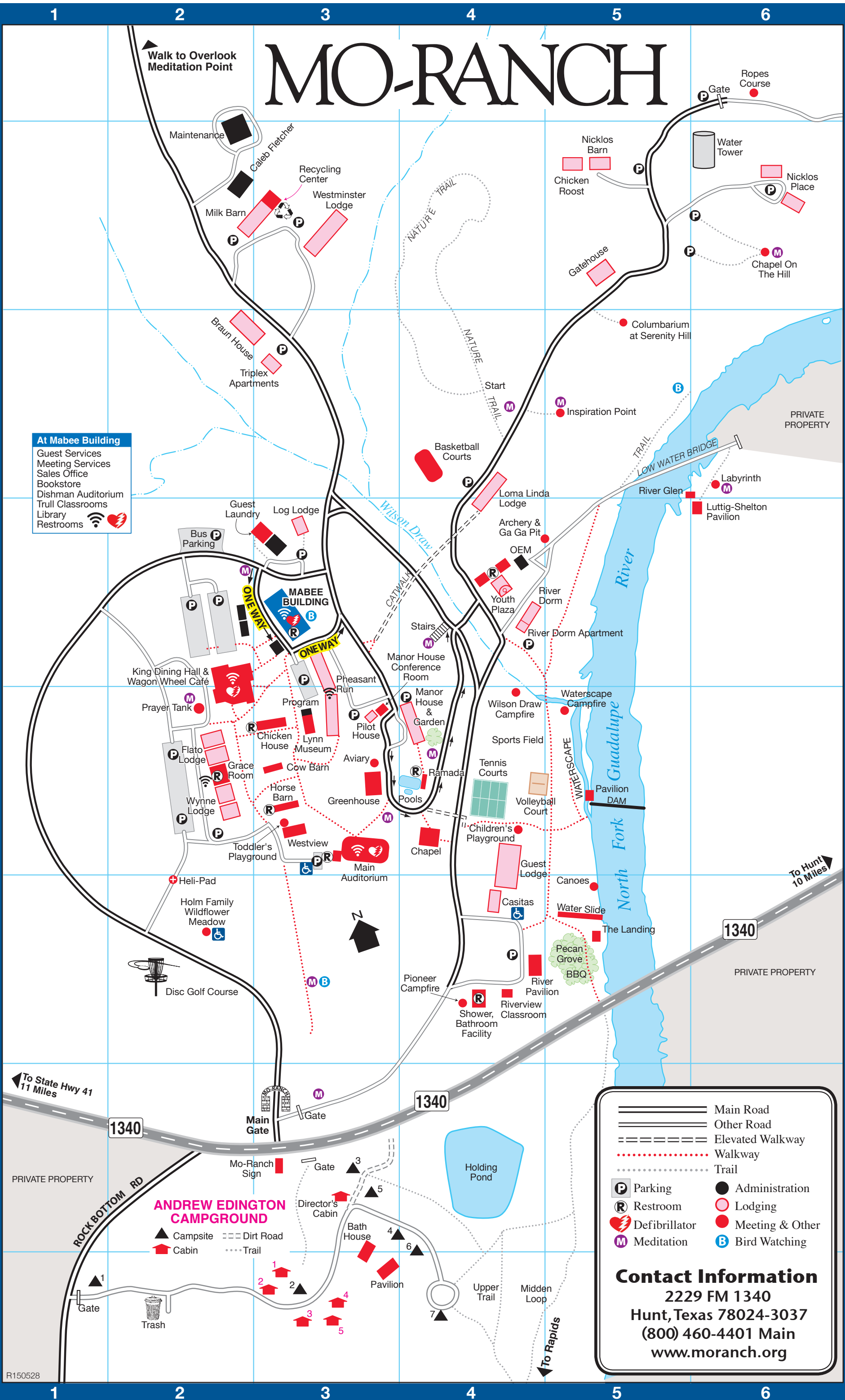

# Wynne Lodge



Parking

# Flato Lodge

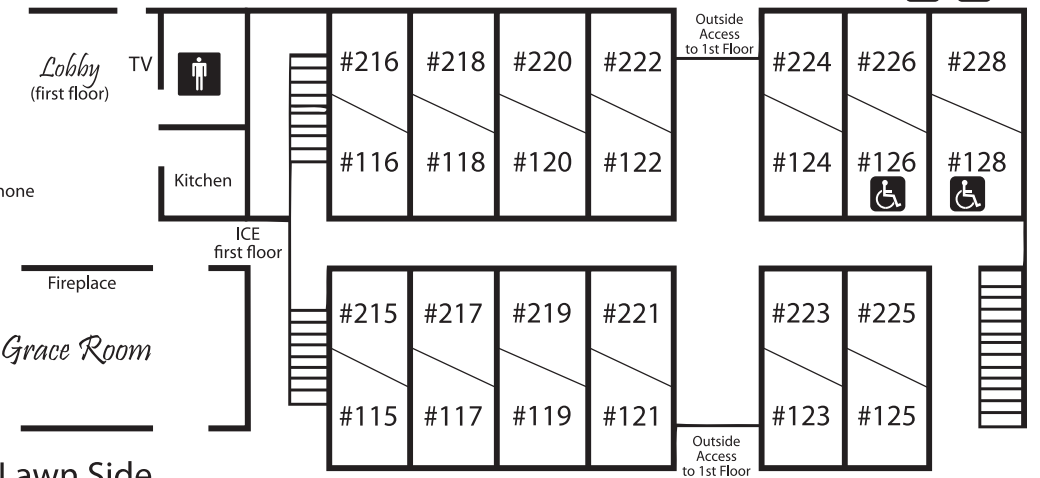

Parking

◀ To Main Auditorium — Pedestrian Path — To King Dining Hall ▶

# Pheasant Run

HOTEL ROOMS

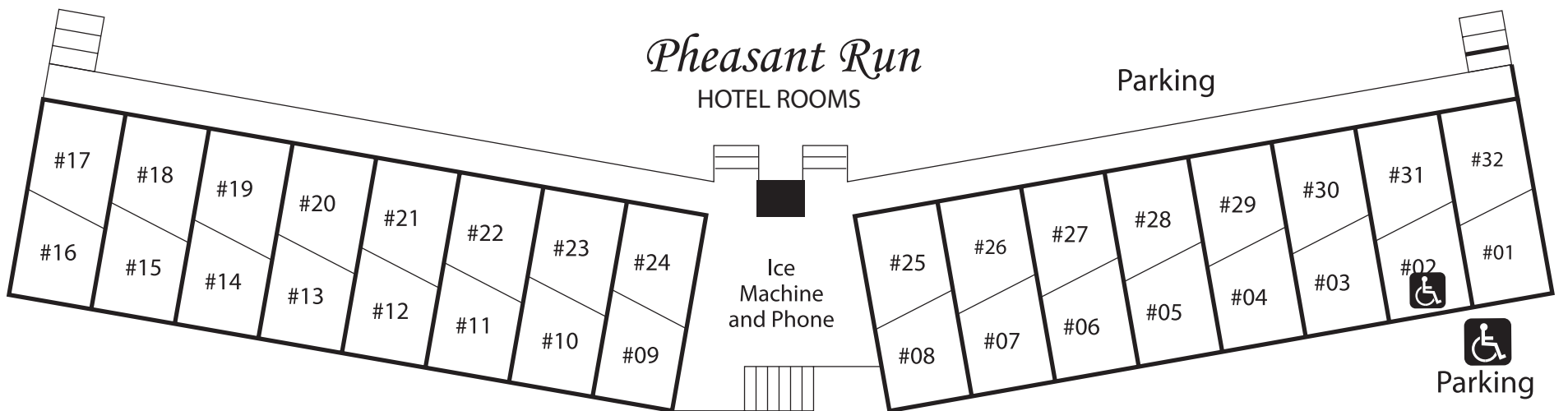

Parking

Parking

# Welcome

to Presbyterian Mo-Ranch Assembly! Nestled on 500 acres along the spring-fed Guadalupe River, Mo-Ranch is located in the heart of the beautiful Hill Country in Hunt, TX. Open year-round to the public for spiritual retreats, conferences, camps, reunions, corporate/group meetings, vacation getaways, individual reservations and more.

Mo-Ranch organizes more than 20 diverse Christian conferences and retreats each year, co-ed residential Christian summer camp and day camp programs and an outdoor education ministry that has served schools and other groups since 1989. Visit our website to learn more about us at [www.moranch.org](http://www.moranch.org).

## MEET

Experience first-class meeting facilities with over 20,000 square feet of meeting space and a wide variety of spaces for all styles. Choices range from modern, traditional, or historical meeting spaces with impressive architectural details. Mo-Ranch is the perfect venue for your next conference or event with a wide variety of meeting spaces and facility capacities for all sizes up to 500.

## STAY

Choose from one-of-a-kind stunning Spanish styled mansions, modern hotel rooms and rustic touches of the Hill Country intertwined throughout apartments, dormitory housing, cabins and campground areas. Dining is available year-round in the King Dining Hall with a wide variety of savory and fresh buffet-style breakfast, lunch and dinner options prepared daily by our culinary staff. Custom catering options are available for special event needs. Onsite shopping is available in the Mo-Ranch gift shop/bookstore.

## PLAY

Experience adventure with an abundance of outdoor activities: state of the art high and low ropes course, 38' rock climbing wall, zip lining, rappelling off the catwalk, hiking trails and archery. Exciting activities include arts and crafts programming, basketball, tennis, sand volleyball, disc golf, soccer, kickball, softball, ping pong, horseshoes, gaga ball pits and more. Water activities include an Olympic size pool and neighboring children's pool, 35' high and 116' long Mo water slide, swimming in the crystal clear Guadalupe river, kayaking, canoeing, snorkeling and fishing.

## MEET. STAY. PLAY. PRAY 365 DAYS A YEAR.

The Mission of Presbyterian Mo-Ranch Assembly is to foster growth in God through Jesus Christ by sharing its unique living, learning, Christian environment.

# MO-RANCH • INDEX

To Map Features (see reverse side)

## ADMINISTRATION

Finance Office . . . . . Go To Mabee Building  
Human Resources Office . . . . . Go To Mabee Building  
Mabee Building . . . . . D3  
President's Office . . . . . Go To Mabee Building  
Program Office . . . . . Go To Mabee Building

## LODGING

Braun House . . . . . B-C-2,3  
Casitas . . . . . F4  
Chicken Roost . . . . . B5  
Flato Lodge . . . . . E2  
Gatehouse . . . . . B5  
Guest Lodge . . . . . E4  
Log Lodge . . . . . D3  
Loma Linda Lodge . . . . . C4  
Manor House & Garden . . . . . E4  
Milk Barn . . . . . B3  
Nicklos Barn . . . . . B5  
Nicklos Place . . . . . B6  
Pheasant Run . . . . . D-E3  
Pilot House . . . . . E3  
River Dorm . . . . . D4  
River Dorm Apartment . . . . . D4  
Triplex Apartments . . . . . C3  
Westminster Lodge . . . . . B3  
Wynne Lodge . . . . . E2

## MEETING PLACES

Barn Theatre . . . . . B3  
Chapel . . . . . E4  
Chapel On The Hill . . . . . B6  
Chicken House . . . . . E3  
Cow Barn . . . . . E3  
Dishman Auditorium (Mabee Building) . . . . . D3  
Grace Room (Wynne/Flato Lodge) . . . . . E2  
Horse Barn . . . . . E3  
Luttig-Shelton Pavilion . . . . . D6  
Main Auditorium . . . . . E3  
Manor House Conference Room . . . . . E3  
Pecan Grove (BBQ) . . . . . F5  
Prayer Tank . . . . . E2  
Ramada . . . . . E4  
River Glen . . . . . C5  
River Pavilion . . . . . F4  
Riverview Classroom . . . . . F4  
Trull Classrooms . . . . . D3  
Westview . . . . . E3

## OTHER PLACES OF INTEREST

Archery . . . . . D4  
Aviary . . . . . E3  
Basketball Courts . . . . . C4  
Children's Playground . . . . . E4  
Canoes . . . . . F5  
Catwalk . . . . . D3-4  
Disc Golf Course . . . . . F2  
Ga Ga Pit . . . . . D4  
Greenhouse . . . . . E3  
Guest Laundry . . . . . D3  
Holm Family Wildflower Meadow . . . . . F2  
Inspiration Point . . . . . C5  
King Dining Hall . . . . . D2  
Labyrinth . . . . . C6  
Lynn Museum . . . . . E3  
Maintenance . . . . . B2  
Pioneer Campfire . . . . . F4  
Recycling Center . . . . . B3  
Ropes Course . . . . . A6  
Shower, Bathroom Facility . . . . . F4  
Sports Field . . . . . E4  
Swimming Pools . . . . . E4  
Tennis Courts . . . . . E4  
The columbarium at Serenity Hill . . . . . 5C  
The Landing . . . . . F5  
Toddler's Playground . . . . . E3  
Volleyball Court . . . . . E4  
Wagon Wheel Café . . . . . D2  
Water Slide . . . . . F5  
Waterscape . . . . . E5  
Waterscape Campfire . . . . . E5  
Wilson Draw Campfire . . . . . E4  
Youth Plaza . . . . . D4

## OTHER

Caleb Fletcher staff housing . . . . . B2-3

