

# Westminster

Guests: 16

The newest facility on the ranch features a large family/meeting room with lovely wood floors, sunny windows and high, raftered ceilings. Sleeps 16 people in four separate hotel type rooms, each with one queen bed, one set of bunk beds and a private bath. Each unit shares an adjoining common area with kitchen.

All linens are provided in rooms. We provide towels for swimming in the river (in the shade shelter between the slide and rope swing) and at the pool (in the shade near the deep end). Please leave your pets at home, as pets are not permitted at Mo-Ranch.

Check In Time: 4:00 pm  
Check Out Time: Noon

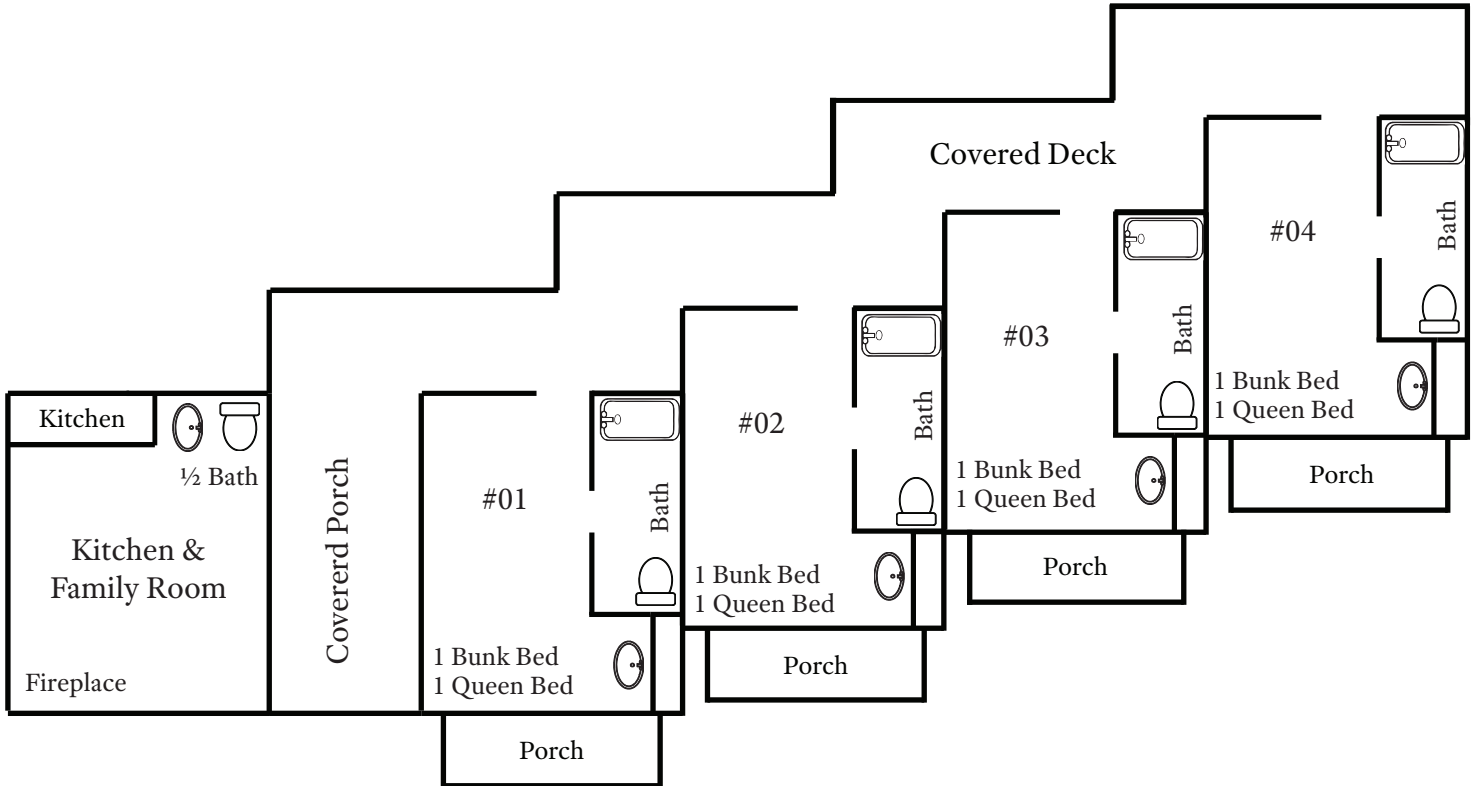
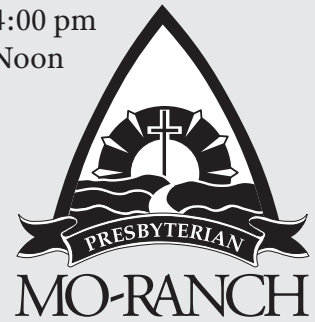

**Group:** \_\_\_\_\_ Please print guest's names within the appropriate room and fax to (830) 238-4202

| #01 | #02 | #03 | #04 |
|-----|-----|-----|-----|
| 1.  |     | 1.  | 1.  |
| 2.  |     | 2.  | 2.  |
| 3.  |     | 3.  | 3.  |
| 4.  |     | 4.  | 4.  |