

Flato Lodge

Check In Time: 4:00 pm
Check Out Time: 11:00 am

Ground Level

Guests: 26 Rooms (2 Levels)

Comfortable, private hotel style accommodations; each room sleeps four with two queen-sized beds and private bath. Room #128 is wheelchair accessible.

All linens are provided in rooms. We provide towels for swimming in the river (in the shade shelter between the slide and rope swing) and at the pool (in the shade near the deep end). Please leave your pets at home, as pets are not permitted at Mo-Ranch.

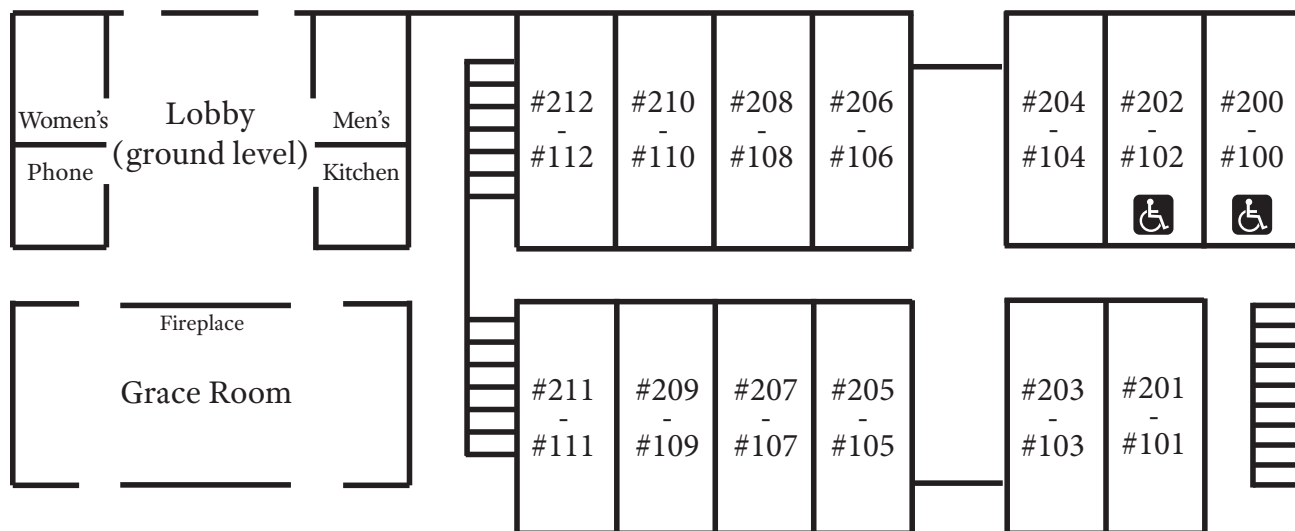

Room #100	Room #101	Room #102	Room #103	Room #104
1.	1.	1.	1.	1.
2.	2.	2.	2.	2.
3.	3.	3.	3.	3.
4.	4.	4.	4.	4.
Room #105	Room #106	Room #107	Room #108	Room #109
1.	1.	1.	1.	1.
2.	2.	2.	2.	2.
3.	3.	3.	3.	3.
4.	4.	4.	4.	4.
Room #110	Room #111	Room #112		
1.	1.	1.		
2.	2.	2.		
3.	3.	3.		
4.	4.	4.		

Flato Lodge

Upper Level

Guests: 26 Rooms (2 Levels)

Comfortable, private hotel style accommodations; each room sleeps four with two queen-sized beds and private bath.

All linens are provided in rooms. We provide towels for swimming in the river (in the shade shelter between the slide and rope swing) and at the pool (in the shade near the deep end). Please leave your pets at home, as pets are not permitted at Mo-Ranch.

Check In Time: 4:00 pm
Check Out Time: 11:00 am

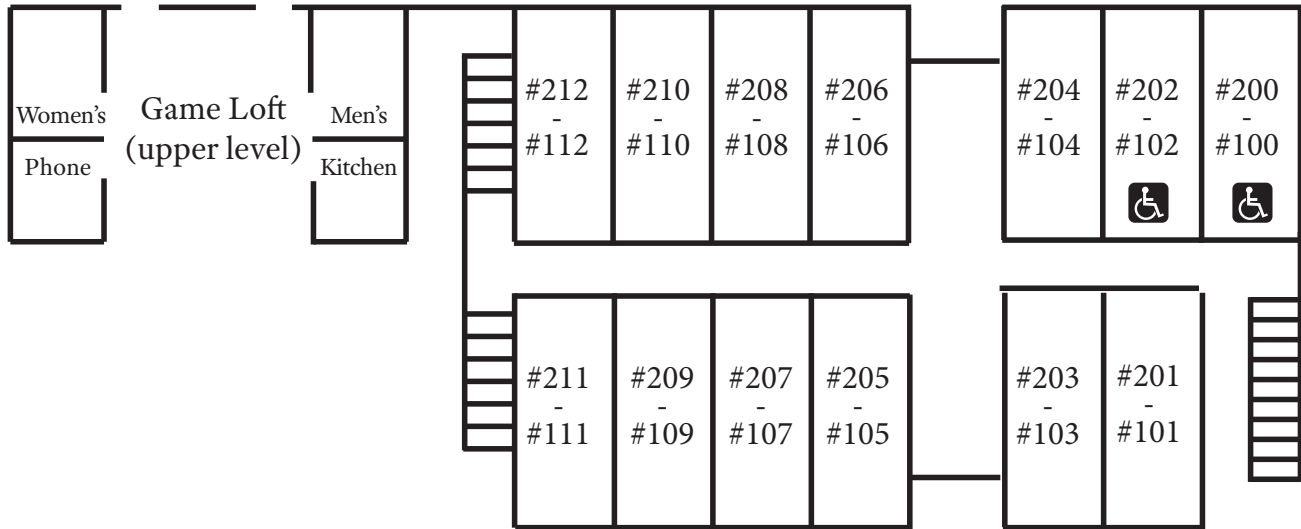

Room #200	Room #201	Room #202	Room #203	Room #204
1.	1.	1.	1.	1.
2.	2.	2.	2.	2.
3.	3.	3.	3.	3.
4.	4.	4.	4.	4.
Room #205	Room #206	Room #207	Room #208	Room #209
1.	1.	1.	1.	1.
2.	2.	2.	2.	2.
3.	3.	3.	3.	3.
4.	4.	4.	4.	4.
Room #210	Room #211	Room #212		
1.	1.	1.		
2.	2.	2.		
3.	3.	3.		
4.	4.	4.		